

PLAN DE SITUATIE  
SCARA 1:5000  
T20, Ns142, Extravilanul Loc. Sulina, Jud. Tulcea

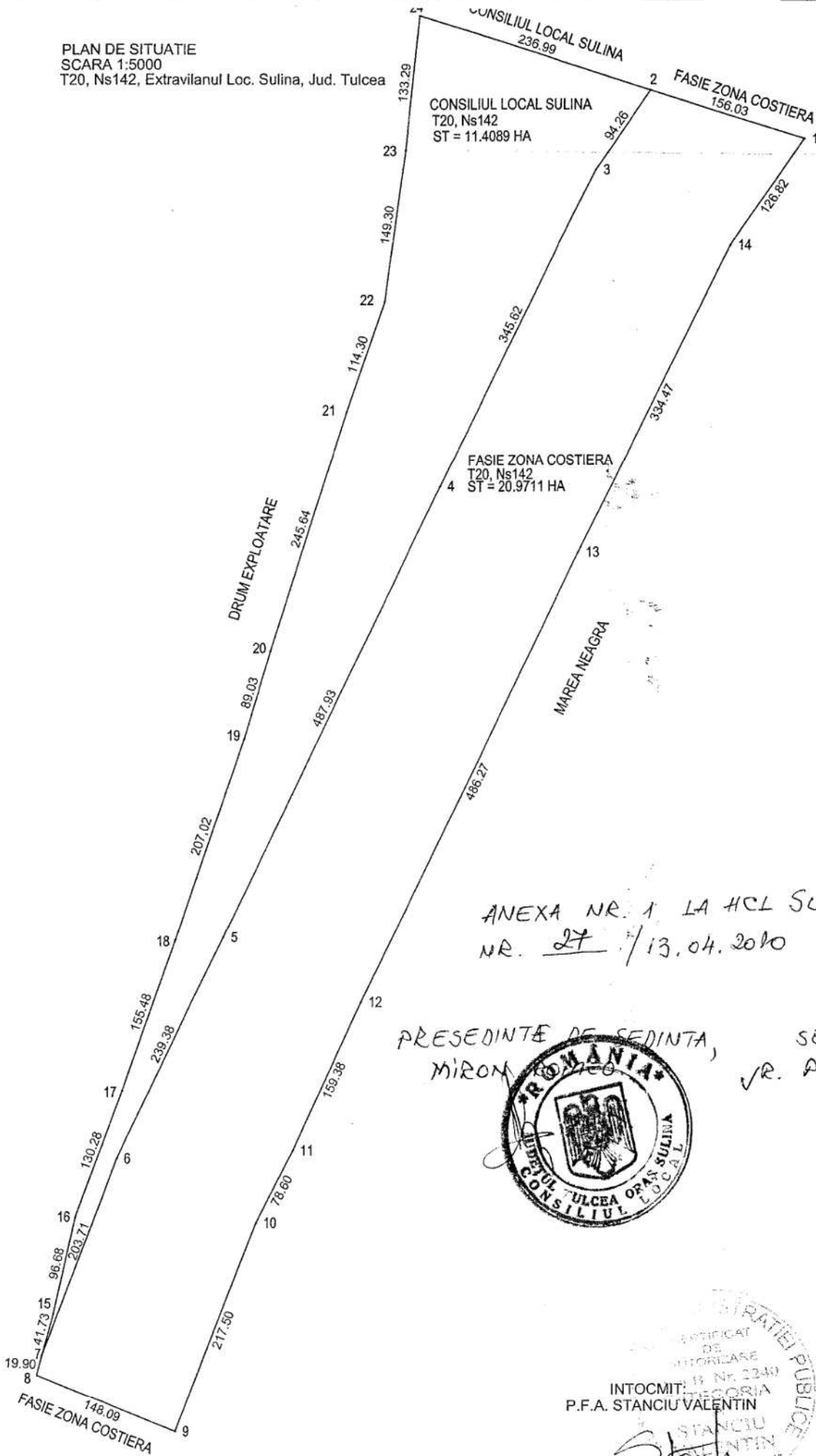

PRESEDINTE DE SEDINTA,  
MIRON ROMEO



SECRETAR,  
JR. PICU ALINA

INTOCMIT DE  
P.F.A. STANCIU VALENTIN

STANCIU VALENTIN