

PLAN DE SITUATIE  
 UNITATEA ADMINISTRATIV TERITORIALA SULINA  
 Scara 1 : 1500

- AMPLASARE TEREN CONCESIONAT CONFORM  
 "CONTRACT DE CONCESIUNE" NR. ... din ...
- ZONA ISLAZ; EXTRAVILAN ORAS SULINA
- LOT NR. 10
- SUPR. TEREN = 1,5 ha.

A ANEXA LA PROCES VERBAL DE  
 II PREDARE - PRIMIRE NR. ... din ...  
 I

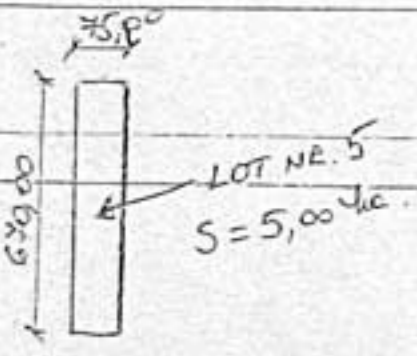
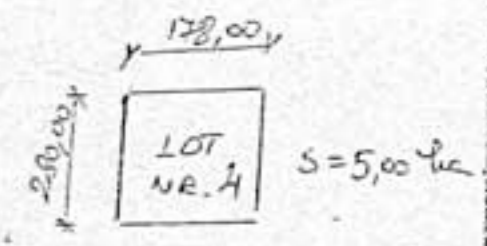
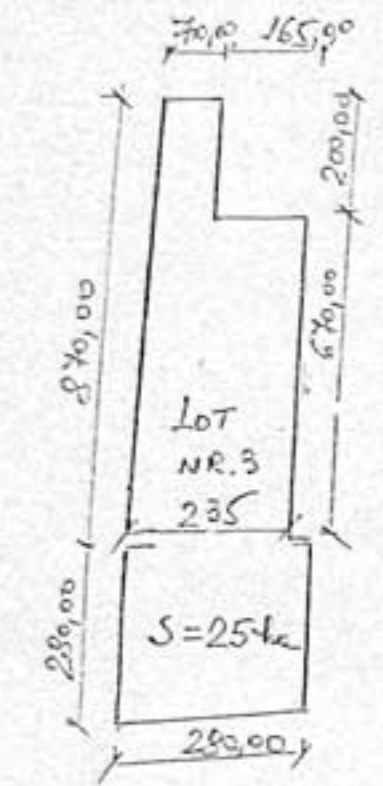

200,00	LOT NR. 3 S = 1,00 ha	LOT NR. 1 S = 1,00 ha	LOT NR. 2 S = 1,00 ha	LOT NR. 10 S = 1,5 ha
50	50	50	45	

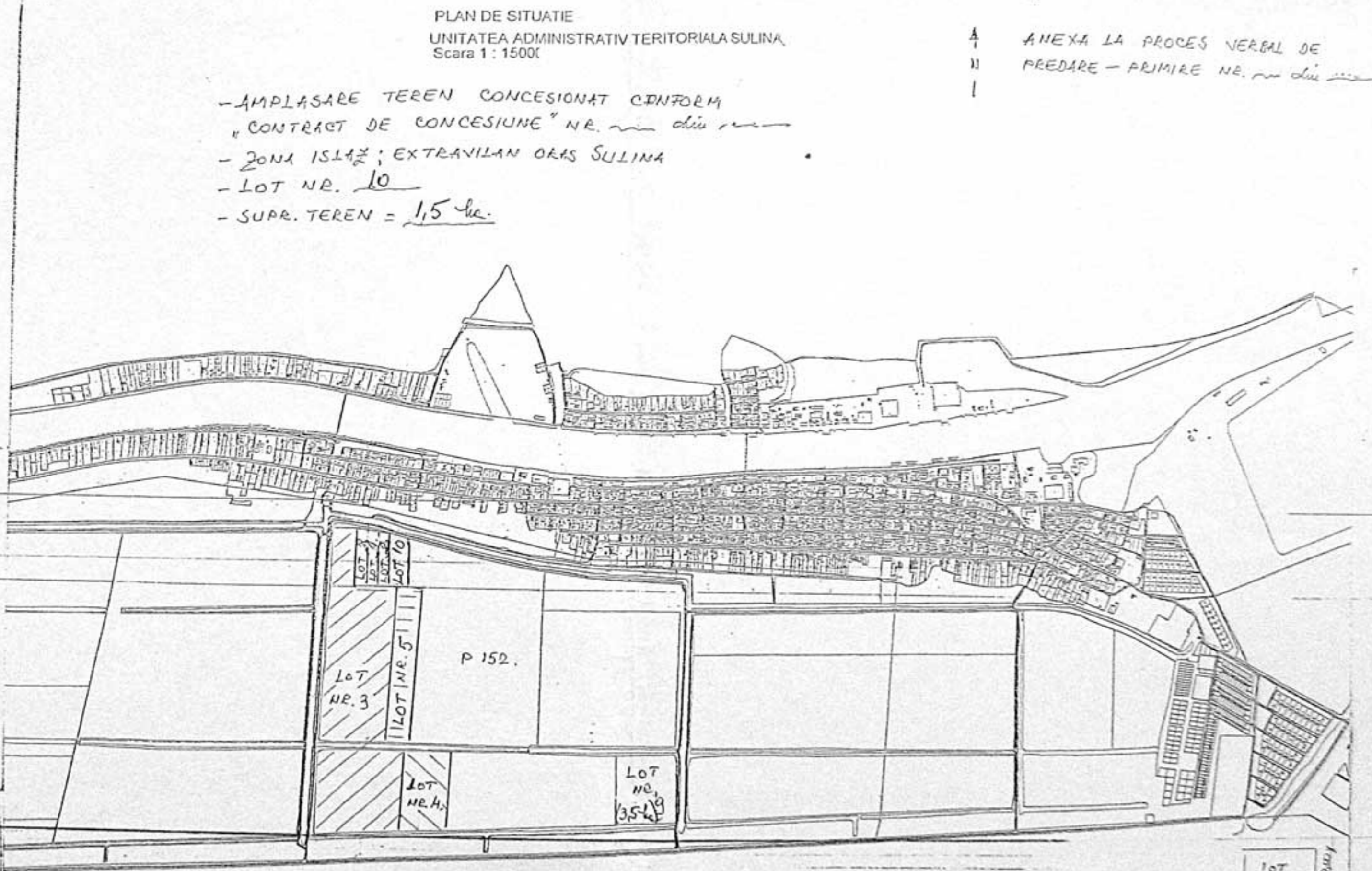

BIROU URBANISM  
 REP. SP. ISMS AUREL

